

SIX-WAY MEMORY POWER UNIT USER MANUAL



Seats Incorporated

1515 Industrial Street

Reedsburg, WI 53959

(608) 524-8261 / Toll Free: 1-800-443-0615

Contents

Introduction 3

Safety Alert Signals..... 3

Six-Way Memory Power Unit Components 4

Transmission Line Connection 5

Programming the Memory System 6

Using the Programmed Memory Unit..... 8

Changing a Programmed Location 8

Troubleshooting 9

Maintenance 10

Introduction

Thank you for purchasing the Six-Way Memory Power Unit from Seats Incorporated. This product was designed to provide many years of worry-free service. Should you experience difficulty during the operation or maintenance of the product, please call our Customer Service Department. **Do not attempt to alter or modify the design of the Six-Way Memory Power Unit.**



This manual provides step by step instructions to properly operate your Six-Way Memory Power Unit. It is important to read and follow all directions carefully. Items requiring special attention are labeled throughout this manual as show below.

Safety Alert Signals

	WARNING!
This warning alerts the customer to avoid possible serious injury or death as a result of improper installation or use.	

	CAUTION
This safety warning alerts the customer to avoid possible injury and/or property damage as a result of improper installation or use.	

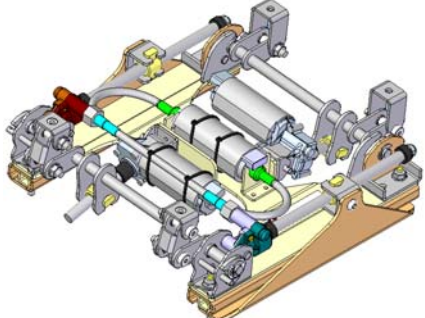
Six-Way Memory Power Unit Components

Seats Inc. Part Number	Description	Image
782213	Six-Way Power Unit	
782240	Memory Switch and Harness Assembly	
782241	Memory Control Module	

Transmission Line Connection

1. A transmission safety feature is designed into the control module to prevent the memory system from being activated while the vehicle is in motion. This safety feature needs to be connected for proper operation of the six-way memory power unit. The vehicle has a transmission enabled signal line that needs to be connected to the white or pink pigtail wires located at the switch connector of the control module (see Figure 1).

If your vehicle provides a +12 V signal while the transmission is NOT engaged, connect the transmission enabled signal wire to the pink pigtail. If the vehicle provides a GROUND signal when the transmission is NOT engaged, connect the transmission enabled signal wire to the white pigtail.

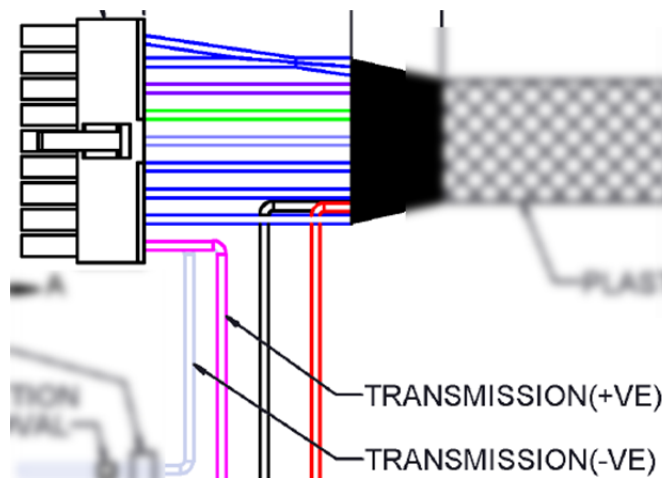

Figure 1: Transmission Line Connection

2. Once this feature is connected, all six-way memory functions will operate correctly when the vehicle is parked. If the vehicle is in gear, memory positions cannot be activated. However; all other features will operate, including the manual power adjustment of the power unit.

Programming the Memory System

The memory system of this six-way power unit allows the user to program the seat to automatically adjust to their specific needs with the press of a button.

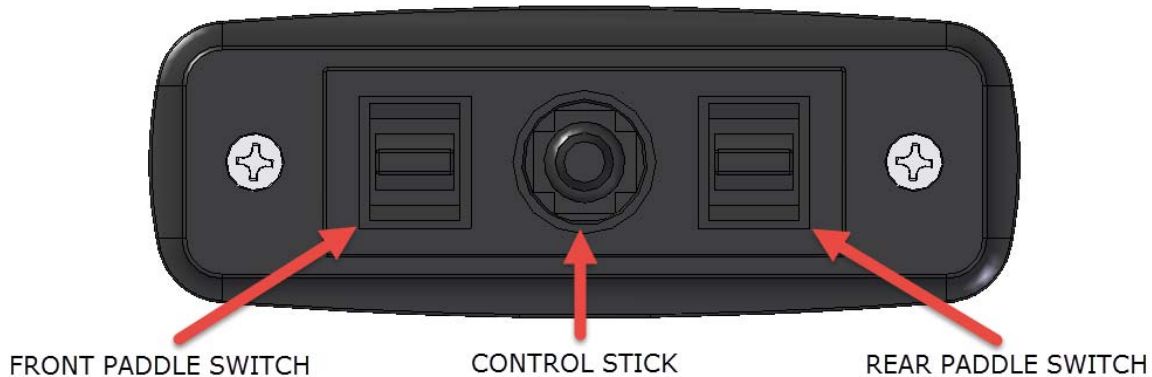

Figure 2: Manual Control Panel

In order for the seat to “remember” any position, the six-way memory power unit must be programmed and stored in the memory control module.

1. Using the front paddle switch, the control stick, and the rear paddle switch (Figure 2), move the seat into the desired seating position. The seat adjust controls are as follows:

<u>Front Paddle Switch</u>	<u>Control Stick</u>	<u>Rear Paddle Switch</u>
Controls the front motor. <ul style="list-style-type: none">• Up: Raises the front of the unit.• Down: Lowers the front of the unit.	Controls up, down, forward, and rearward operation <ul style="list-style-type: none">• Up: Raises entire unit.• Down: Lowers the unit.• Forward: Moves unit forward.• Rearward: Moves unit rearward.	Controls the rear motor. <ul style="list-style-type: none">• Up: Raises the rear of the unit.• Down: Lowers the rear of the unit.

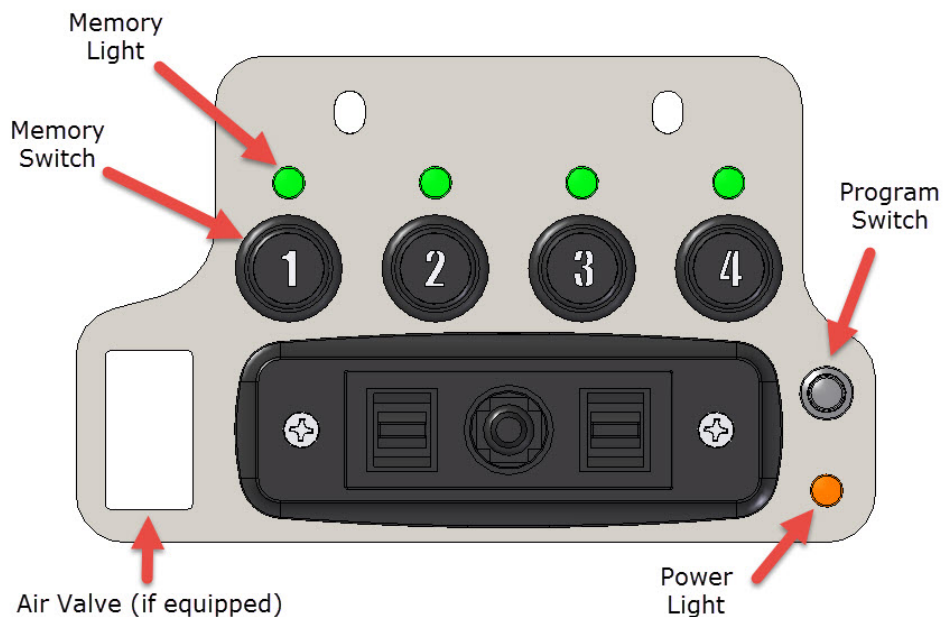

Figure 3: Memory Control Panel

2. When the power unit is positioned to the desired location, press and hold the Program Switch for 3 seconds. All of the green memory positions lights will flash. The Program Switch can be released and this indicates the system is ready to set a position to memory.
3. While all the green lights are flashing, press the Memory Switch you wish to program. For instance, to program position “one”, press Memory Switch Button 1. The green light above the Memory Switch will illuminate and the power unit is now programmed to the location.
4. Repeat steps 1-3 to program other memory locations. The Six-Way Memory Power Unit can hold up to (4) programmed locations.

Using the Programmed Memory Unit

To move the power unit to a programmed location, press one of the Memory Switch buttons that has been preset to a location. When the button is pressed, the seat will automatically adjust to the programmed position.

NOTE: The power unit will not move to a programmed location when the vehicle is in gear. If the power unit is travelling to a selected memory location when the vehicle is placed in gear, it will complete the operation.

Changing a Programmed Location

To change a previously programmed memory location, follow the steps in the section “Programming the Memory System”.

NOTE: Moving the power unit to a new location and programming the new location will override any pre-existing programming for the selected memory switch.

Troubleshooting

The amber (power) and green (memory) light indicators act as a troubleshooting guide for the user. Please refer to this list should any problems occur with the Six-Way Memory Power Unit.

Key: ● On ○ Off * Flashing

Amber Light	Green Lights (flash)	Problem	Solution
●	●	Seat is not in programmed memory location.	
○	○	Sleep Mode	Start vehicle and put into gear or press any control button to deactivate "Sleep Mode".
○	○	No Power to Seat Control.	<ol style="list-style-type: none"> 1. Check 30 Amp fuse. Replace with appropriate fuse if blown. 2. Power cable disconnected. Check wiring for cable disconnections. 3. Vehicle battery dead.
*	* (Any/All)	During power-up: Green flashing lights indicate that those memory locations are not set.	Set memory location.
*	* (One)	If when memory button is pressed: Memory at that location is not set.	Set memory location.
*	* (One)	If after travel to a location: Power unit stalled before achieving programmed location.	<ol style="list-style-type: none"> 1. Move power unit with manual controls and then press the desired memory. 2. Manually move seat to desired location and reset the memory location.

NOTE: To check the fuse, open the inline fuse cap as shown in Figure 4 and inspect the fuse. If the fuse is discolored or the fuse has blown, replace with another 30 Amp Automotive Fuse

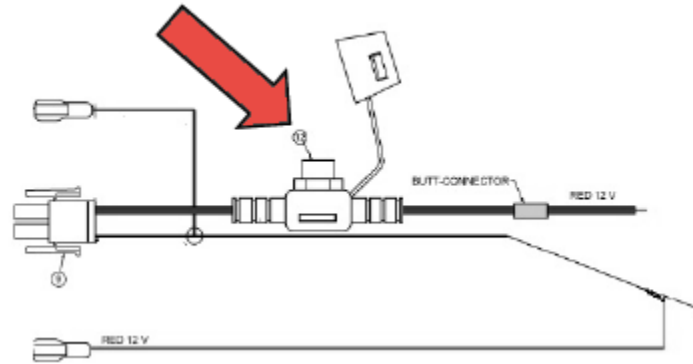

Figure 4: Inline 30 Amp Fuse

Maintenance

The Six-Way Memory Power Unit has been designed to be maintenance free throughout the life of the unit. No additional maintenance is necessary.

The memory control panel can be cleaned with a mild interior automotive/household cleaner and a damp cloth. Do not remove the control panel while cleaning.

When cleaning the control panel or memory module, be sure water and/or cleaning chemicals do not get inside the panel or module. Additional water or cleaning chemicals in the unit can cause premature corrosion and/or failure to the electrical components.