

HALO

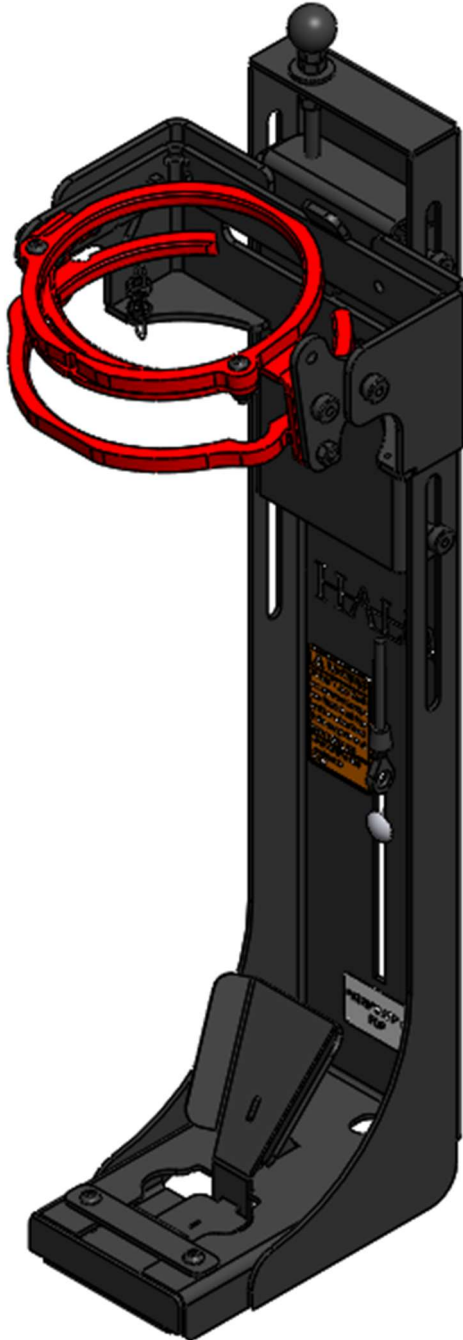

712508 Revision: 05 Revision Date: 02/24/2023
Member of the Nordic Group of Companies, Ltd.
U.S. Patent No. 10,940,777



Table of Contents

Warning	3
Required Tools.....	4
Hardware	4
Basic Assembly	4
Set-up.....	6
Rings.....	6
Installing a Valve Holder:	9
Adjustment and Use.....	11



Failure to follow the instructions in this user guide may result in serious injury or death.

- Read and understand the HALO User Guide before using the HALO.
- Never attempt to service or modify the HALO in any way not expressly described in these instructions.
- Combined weight of SCBA and pack must not exceed 35lbs.
- SCBA pack is not designed to operate as an occupant restraining device. Always wear your seat belt.
- SCBA pack straps should not be worn while the vehicle is in operation.
- Do not use the HALO if rings are not locked and SCBA properly secured (page 12).
- The HALO should be used for SCBA storage only.
- Verify proper fit of SCBA in the HALO upon installation of SCBA (page 12).
- Periodically check operation of the HALO ring assembly by operating the device without an SCBA installed. Ensure rings lock securely and unlock freely.
- Ensure that the proper ring configuration is installed (page 6). **Failure to do so could result in unintended release of SCBA from the HALO.**
- Ensure that the proper valve holder is installed (page 10). **Failure to do so could result in unintended release of SCBA from the HALO.**
- Only use furnished hardware, or equivalent grade 5 hardware, to attach the HALO to mounting locations.
- SCBA and pack should be kept clean and in good working condition.
- For questions regarding the use of the HALO, call 800-443-0615.

Required Tools

- 5/32 inch allen wrench
- 1/4 inch standard wrench
- Torque wrench

Hardware

- Screw: 1/4-20 button socket head cap screw
- Nut: 1/4-20 center locking hex nut

Basic Assembly

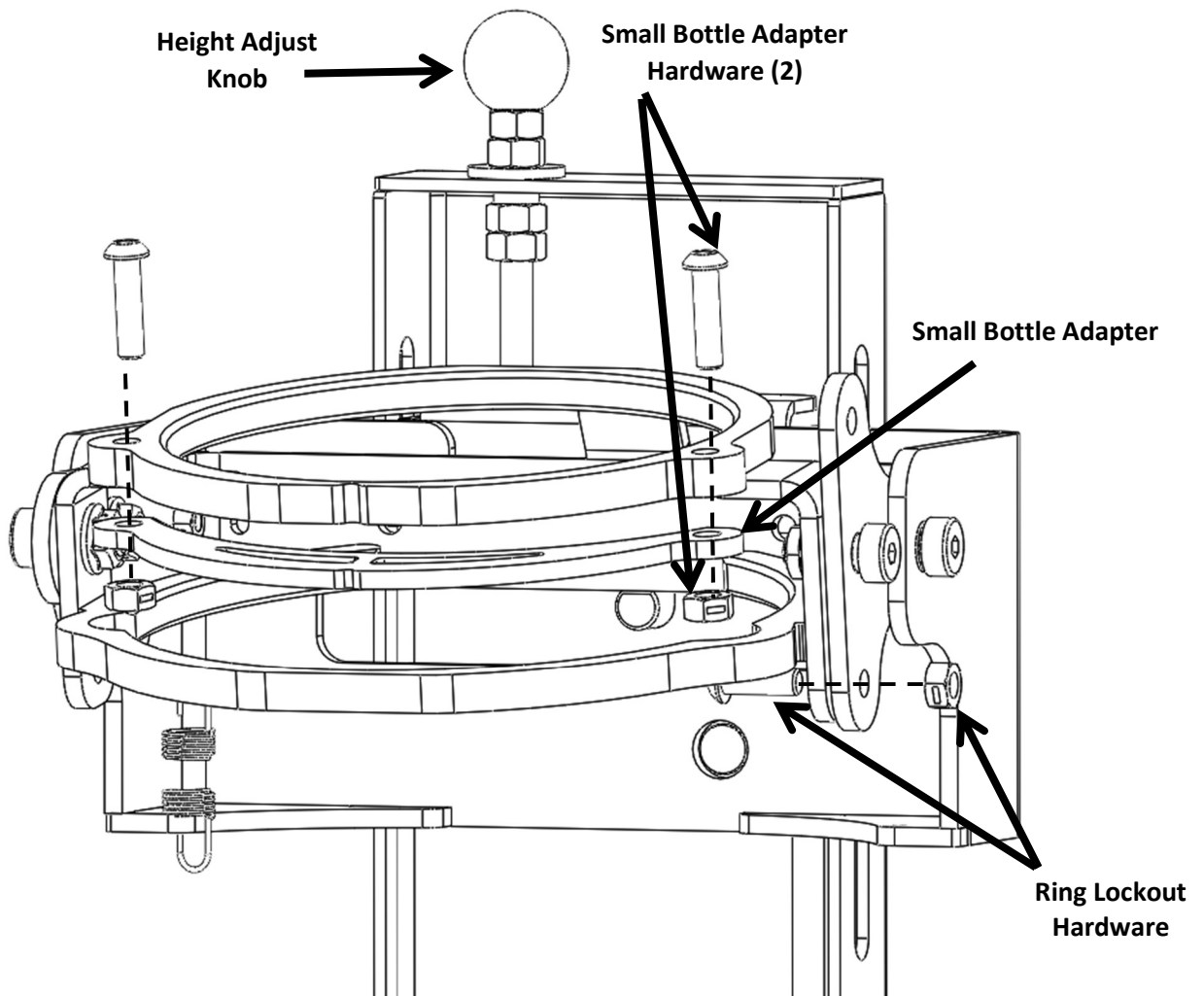

Figure 1: Ring Assembly Components

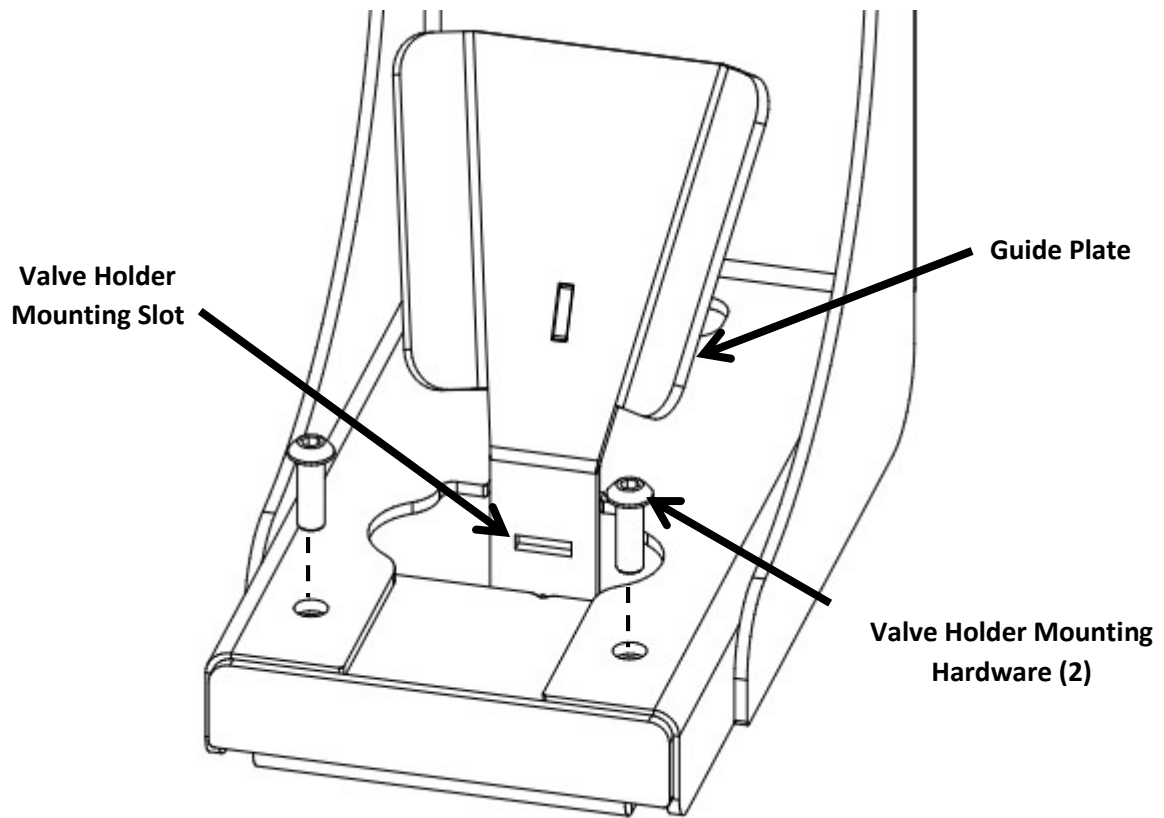

Figure 2: Valve Holder Assembly Components

Set-up

Rings

Step 1:

Determine your bottle diameter

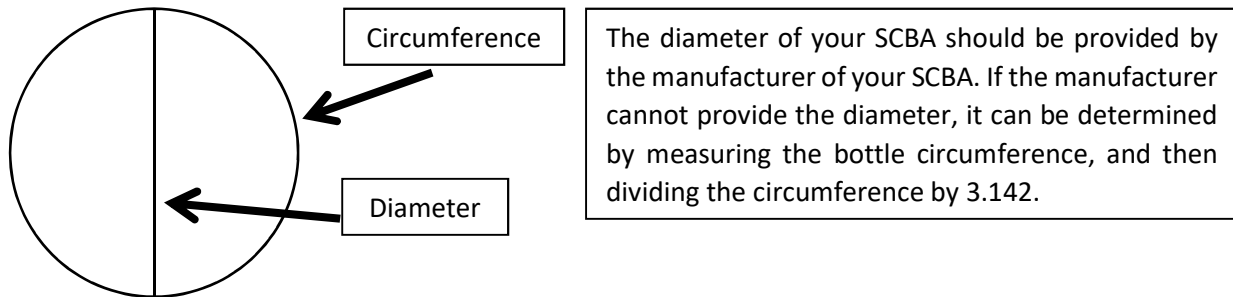

Step 2: Select the proper ring configuration based on bottle diameter

Bottle Diameter (inches)	Configuration	Figure Number
Larger than 6.4	Large Ring	Figure 3
Between 5.7 and 6.4	Small Ring	Figure 4
Below 5.7	Small Ring with Adapter	Figure 5

Note: Use the proper ring configuration for your bottle diameter but verify the fit is appropriate by following the steps under “Use and Adjustment” on page 11. If the fit is not appropriate or there is an interference that is restricting proper fit of the bottle please contact 800-433-0615.

Only follow steps 3-6 of this section if you need to change the configuration of your HALO rings.

Step 3:

Remove the lockout hardware shown in Figure 1.

Step 4:

Rotate the rings to the desired orientation per your bottle diameter.

Step 5:

Re-install ring lockout hardware. Hardware should be torqued to 120-140 in*lbs

Step 6:

IMPORTANT: If you selected the small ring configuration you need to remove the small bottle adapter and small bottle adapter hardware, and retain for future use.

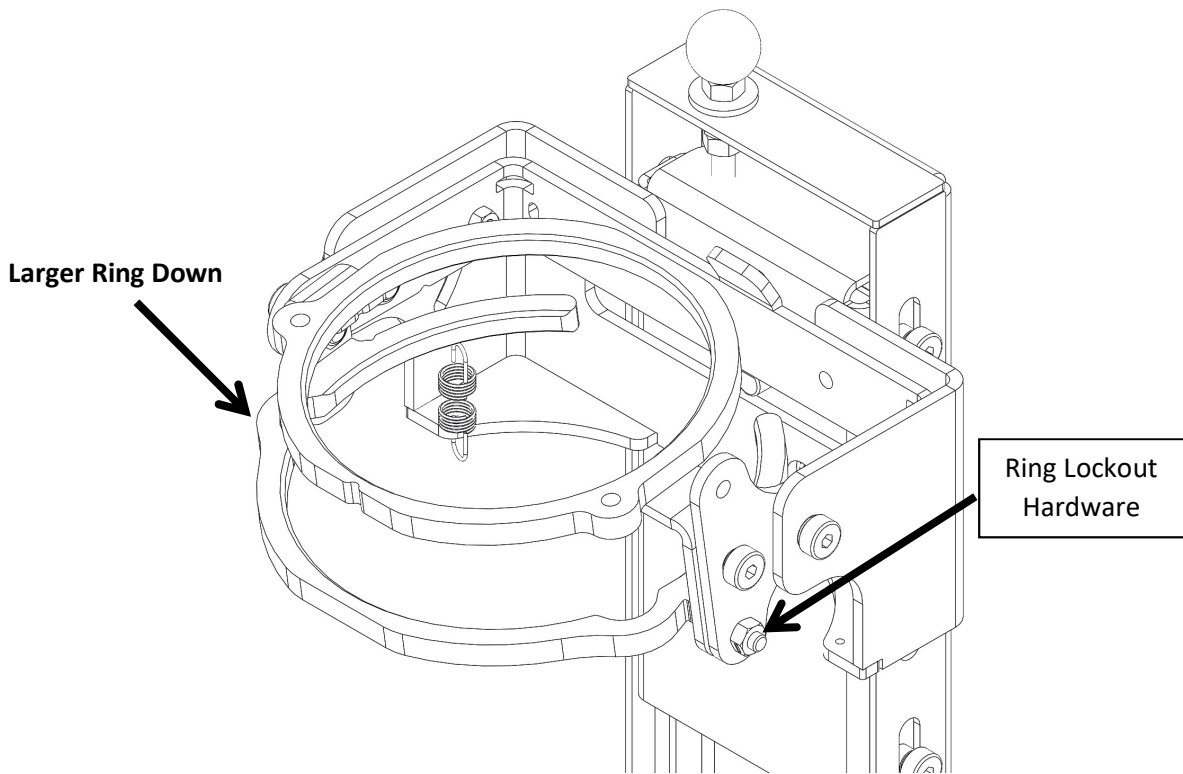

Figure 3: Large Ring Configuration

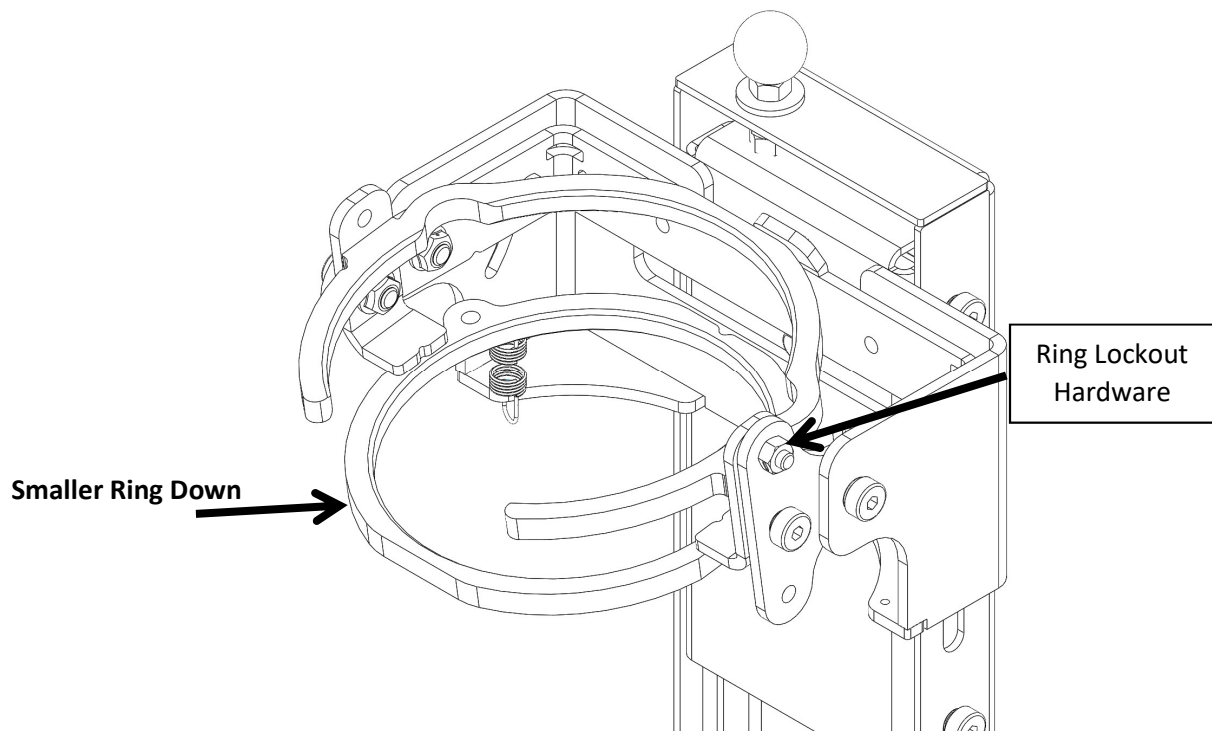

Figure 4: Small Ring Configuration

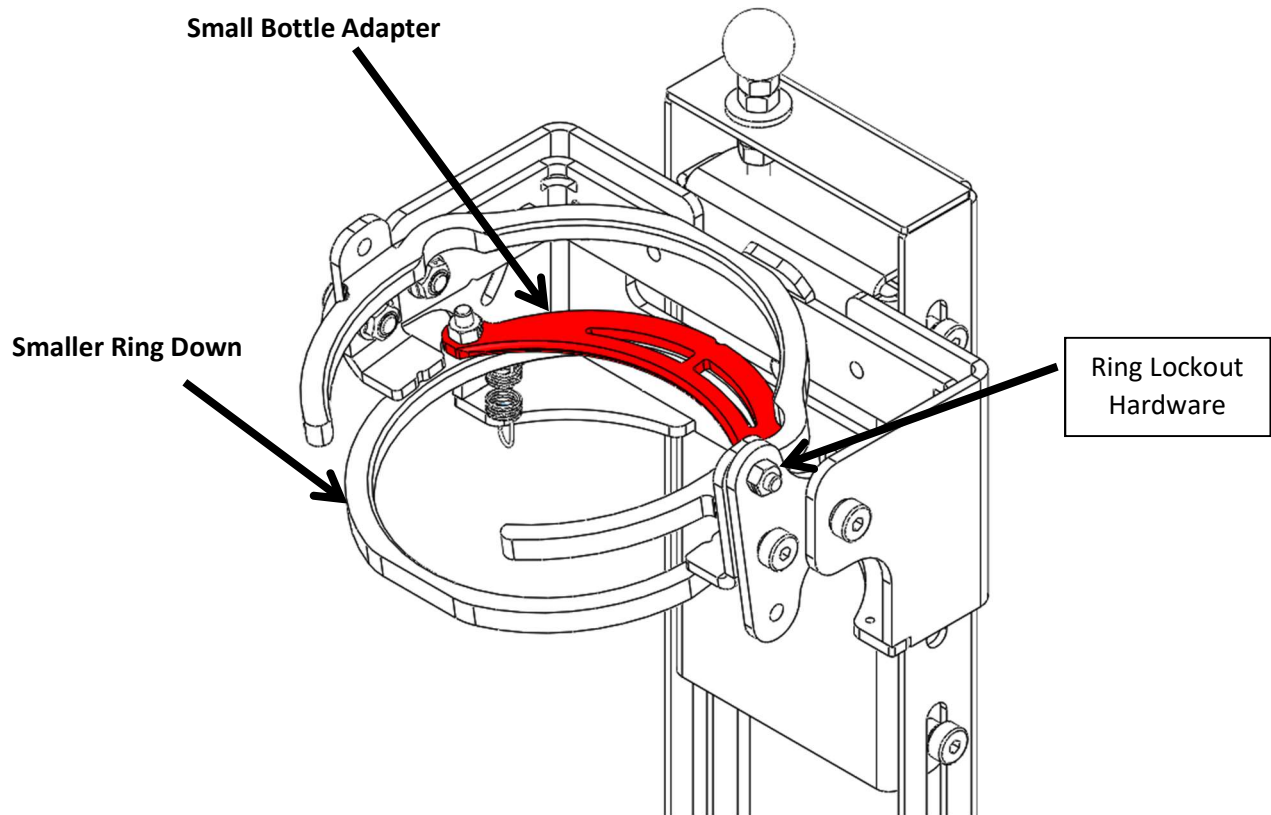

Figure 5: Small Ring with Adapter Configuration

⚠ WARNING

Installing the small bottle adapter in a position or orientation other than illustrated in Figure 5 could result in an SCBA bottle to release unexpectedly.

Installing a Valve Holder:

Step 1:

Select the correct foot adapter for your bottle from Figure 6 and 7 below.

Bracket Identifier

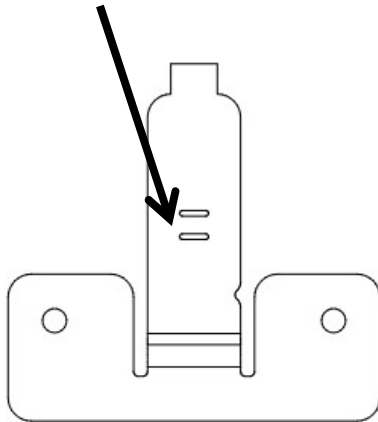

**MSA Short Valve
Holder**

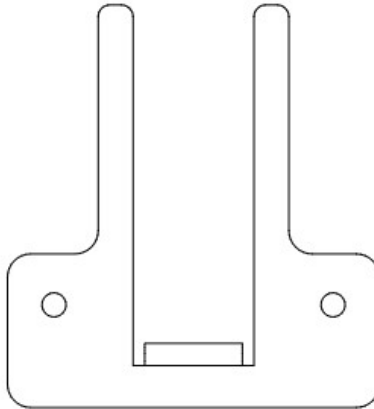

**MSA Tall Valve
Holder**

Bracket Identifier

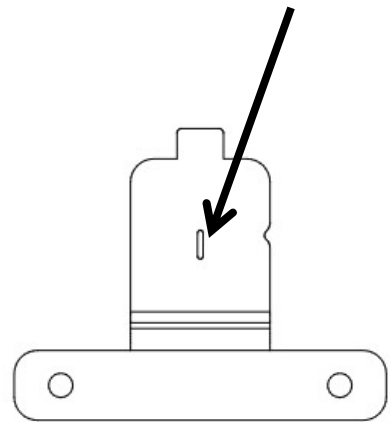

**Scott Valve
Holder**

Figure 6: Valve Holder Brackets



Figure 7: MSA Tall Bottle Valve (Left) MSA Short Bottle Valve (Right)

Note: MSA G1 Valve does not require an additional valve holder.

Step 2:

Insert the tab of the holder into the valve holder mounting slot (Figure 8).

Step 3:

Line up the holes on the valve holder with the holes on the HALO (Figure 9).

Step 4:

Insert both screws and torque each to 120-140 in*lbs. (Figure 10).

Step 5:

Retain the extra foot adapters for future use.

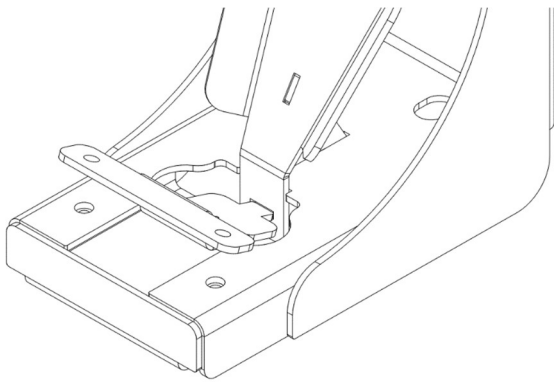

Figure 8: Step 1-Insert tab into slot

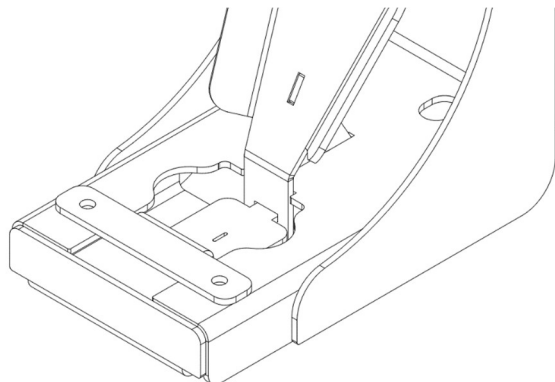

Figure 9: Step 2-Line up holes

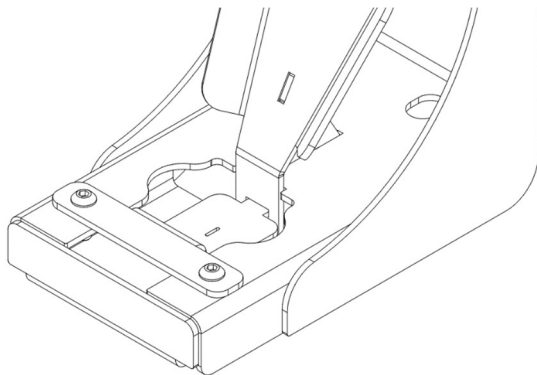

Figure 10: Step 3-Install screws

Adjustment and Use

Step 1:

After selecting the proper valve holder and ring configuration, install the SCBA into the HALO by pressing the SCBA against the rings until the rings latch. If the bottle does not press against the rings to lock the HALO, pull the rings down by hand.

Step 2:

Utilize the height adjust knob to set the proper height. The rings should come in contact with the front and back of the SCBA bottle.

Step 3:

With the HALO in the locked position, verify that the SCBA does not release when firmly pulling on SCBA shoulder harness.

Step 4:

To remove the SCBA from the HALO, release the latch by activating the release lever and pulling on the SCBA shoulder harness.

Step 5:

Verify that the rings lock and unlock properly by using the release.

Note:

Avoid overtightening the HALO by verifying that the SCBA is able to spin slightly, by hand and stays in contact with the ring, when installed.

Important:

If the HALO has been properly set-up but the rings interfere with the SCBA pack, remove the pack and contact 1-800-446-0615 for further assistance.

Note:

The HALO should be inspected periodically to ensure that it is still locking and unlocking properly.